

# Technology for a better life



KCC Decorative Coating & Building Materials



# CONTENTS



COMPANY OVERVIEW  
CORPORATE VISION / PHILOSOPHY  
MID TO LONG-TERM VISION  
MAIN HISTORY  
COMPANY OVERVIEW

---

## CERTIFICATION – THE STATES

UL263 / UL1709 , PROTECTIVE COATING  
LEED CERTIFICATION  
USDA CERTIFICATION

---

## FLOOR COATING

EPOXY FLOOR COATING  
URETHANE FLOOR COATING  
POLYUREA COATING  
KCC CRETE  
KCC HARD FLOOR  
HPP TILE

---

## BUILDING MATERIALS

ACOUSTIC CEILING BOARD  
PVC VYNIL TILE  
TOILET PARTITION  
INSULATION & SEALANT

---

# Underwriter Laboratories(UL) CERTIFICATION

/00

The **UL 263** test is the North American Standard for evaluating fire protection in steel structures. It was developed to simulate the types of fires that occur in commercial buildings, such as offices, schools and hospitals.

**UL 1709**, Rapid Rise Fire Test of Protection Materials for Structural Steel, was first published in 1989. The standard was originally developed to provide fire testing requirements suitable for materials exposed to the rapidly rising high temperatures typically observed in high intensity, hydrocarbon- based fires.

UL No	Product Type	Product Name	Fire Resistance Rating	Standard	Specification	Remark
UL263	Gypsum Board Panel	Fire Resistance Gypsum Board-1hr	1hr	1hr Fire Resistance Structure (C-Stud)	15.9T(5/8 Inch) Fire Resistance G/S + 90 mm C-Stud + 15.9T(5/8 Inch) Fire Resistance G/S	
UL263		Fire Resistance Gypsum Board-1hr		1hr Fire Resistance Structure (CH-Stud)	15.9T(5/8Inch) Fire Resistance G/S + 64 mm C-Stud + 25.4T(1 Inch) Fire Resistance G/S	
UL263		Fire Resistance Gypsum Board-2hr	2hr	2hr Fire Resistance Structure(C-Stud)	15.9T(5/8 Inch) Fire Resistance G/S 2PLY + 65 mm CH-Stud + 15.9T(5/10 Inch) Fire Resistance G/S 2PLY	
UL263		Fire Resistance Gypsum Board-2hr		2hr Fire Resistance Structure(CH-Stud)	15.9T(5/8 Inch) Fire Resistance G/S + 64 mm CH-Stud + 25.4T(5/11 Inch) Fire Resistance G/S	
UL263	Acoustic Celing Board	Miton-Claudia	2hr	2hr Fire Resistance Ceiling Board Panel	24 by 24 5/8 or 3/4 Inch (600 by 600 15mm or 19mm)	
UL1709	Protective Coating	Firemask SQ3500	30min – 3hr	30min - 3hr Fire resistance	Steel Design Reference	* Oil & Petrochemical Projects * Paint Resin Type: EpoXy
UL263	Decorative Coating	ODM Product	30min – 120min	30min - 120min Fire resistance	Steel Design Reference	* Industrial Building, Factory * Paint Resin Type: Waterbase

# ■ KCC FIRE RESISTANCE BUILDING MATERIAL

\* What needs to be protected?

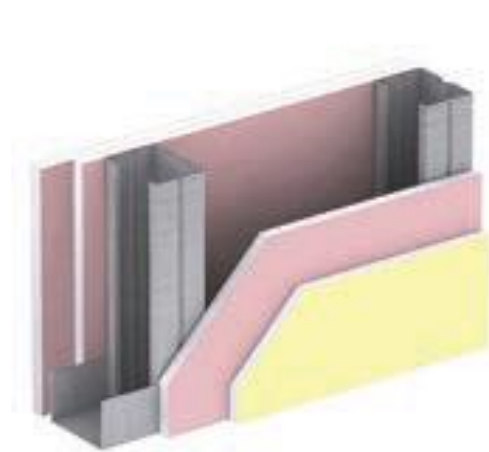
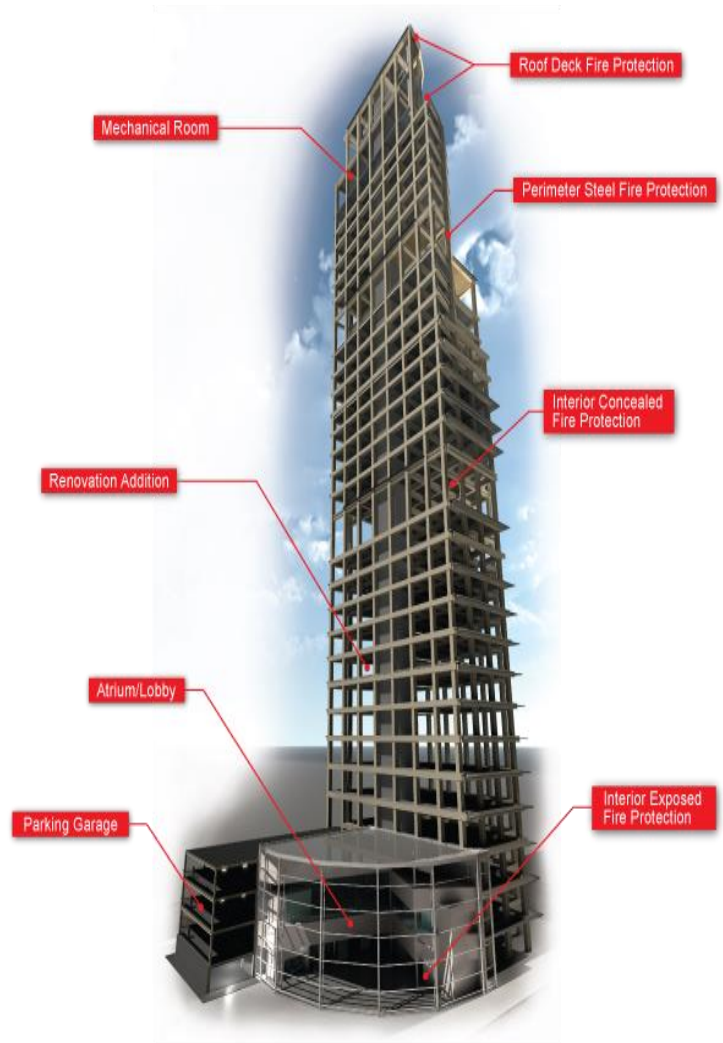

Fire Resistance Gypsum Board

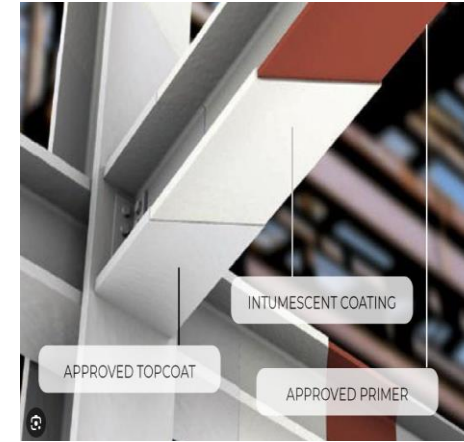

Fireproof Intumescent Paint

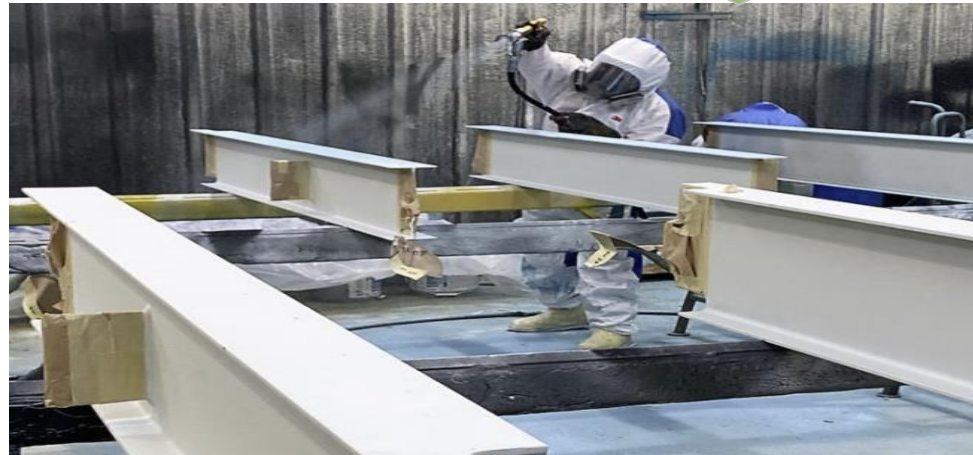

# PROTECTIVE COATING – STEEL COLUMN & BEAM

/00

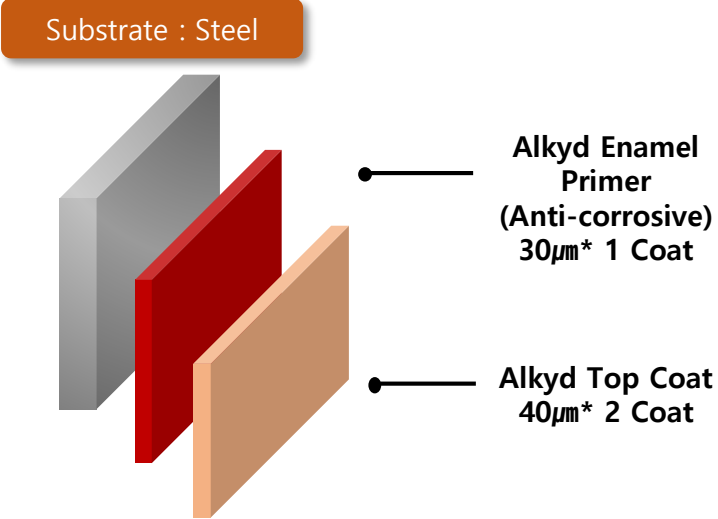
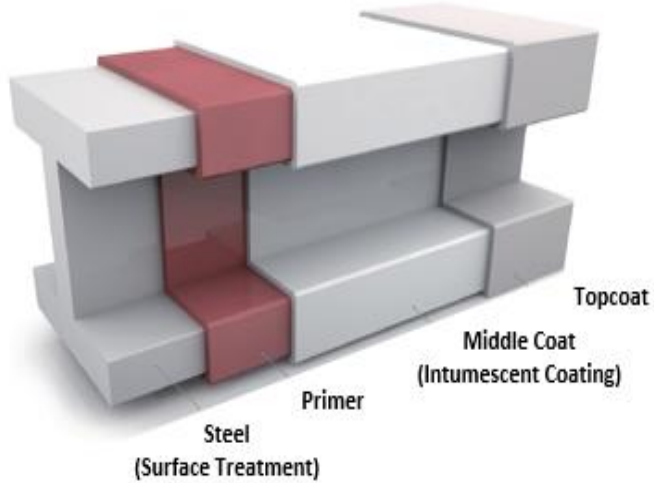
1	NON FIREPROOF COATING	DATE		2	FIREPROOF INTUMESCENT	DATE	
PHOTO	<p>Substrate : Steel</p>  <p>Alkyd Enamel Primer (Anti-corrosive) 30µm* 1 Coat</p> <p>Alkyd Top Coat 40µm* 2 Coat</p>			PHOTO	 <p>Topcoat</p> <p>Middle Coat (Intumescent Coating)</p> <p>Primer</p> <p>Steel (Surface Treatment)</p>		
CODE	Anti-corrosive Primer + Sensemel Top Coat			CODE	1. Primer: EP170(Epoxy Primer) 2. Fire-Proof Coat: (ODM) 3. Top Coat: KCC Sunitan Top Coat(Water borne)		
STANDARD	1. Primer: MP120 40µm 2. Top Coat: LT313 40µm * 2 times			PACKAGE	18Liter / 1 set		
MANUFACTURER	KCC Corporation			MANUFACTURER	KCC Corporation / ODM(America)		
Area/ Reference	Hyundai Motor Manufacture Indonesia LG Ensol EV Battery Indonesia			Area/ Reference	LG Ensol EV Battery Indonesia (British BS476 code Product)		

# PROTECTIVE COATING

Steel Bridges & SOC Steel Structures



Petrochemical Plants



Thermal Power Plants



Chemical Storage Tank



Waste Water Treatment plant



Offshore Steel Structures



248

Projects  
as of December 31, 2017

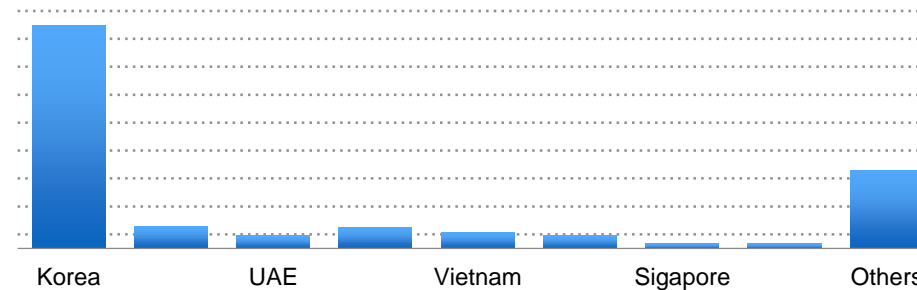

# LEED CERTIFICATION

/00

**Leadership in Energy and Environmental Design (LEED)** is a [green building certification](#) program used worldwide.<sup>[3]</sup> Developed by the non-profit [U.S. Green Building Council](#) (USGBC), it includes a set of rating systems for the design, construction, operation, and maintenance of [green buildings](#), homes, and neighborhoods, which aims to help building owners and operators be [environmentally responsible](#) and use resources efficiently.



Certification Standard		Type	KCC Products		Thickness	Certification Date	Remark
EQ Credit 2	Low-Emitting Materials	VOC Emission	Gypsum Board (9 Items)	Regular Gypsum Board	9.5T	OCT. 2021	
				Regular Gypsum Board	12.5T	FEB. 2021	
				Regular Gypsum Board	15T	FEB. 2021	
				Waterproof Gypsum Board	12.5T	FEB. 2021	
				Waterproof Gypsum Board	15T	FEB. 2021	
				Fire Resistance Gypsum Board	15T	JUNE. 2022	
				Fire Resistance & Waterproof Gypsum Board	15T	JUNE. 2022	
				Soundproof Gypsum Board	12.5T	JUNE. 2022	
				High Waterproof Gypsum Board	12.5T	JUNE. 2022	
			Isulation	Glasswool Nature		FEB. 2021	
			Acoustic Ceiling Board (7 Items)	Miton Sahara	15T	NOV. 2021	
				Mitex 12T	12T	NOV. 2021	
				Miton Claudia	15T	DEC. 2021	
				Plaster Tex	9.5T	OCT. 2022	
MR Credit 2	Environmental Product Declarations	EPD		Miton Claudia	15T	JAN. 2023	
MR Credit 4	Matrrial Ingredients	HPD/C2C		Miton Claudia	15T	JAN. 2023	
EQ Credit 2	Low-Emitting Materials	VOC Emission & VOC Content	Sealant (4 Items)	SL825		NOV. 2011	Anti Bacterial
				PU9330(N)		NOV. 2011	Floor Joint
				SL907 Premium		NOV. 2011	Interior Finish, Glass Glazing
				QS1119E		NOV. 2011	Fire Resistance
			Paint (12 Items)	Supro KS Interior		APRIL.2022	Interior Concrete Wall Paint
				Supro Gloss Plus		APRIL.2022	Anti Contamination, Skirt Board
				Supro Silk		APRIL.2022	Concrete Ceiling
				Hyper Urea PU295A	3T	APRIL.2022	Carpark, Waterproof
				Sporthane High Hard Floor Sealer	3T	APRIL.2022	Carpark Floor
				Sporthane High Hard Floor - Top coat	3T	APRIL.2022	Carpark Floor
				Sunipoxy Primer		APRIL.2022	Waterbase Floor Coating
				Sunipoxy Top Coat		APRIL.2022	Waterbase Floor Coating
				Sunitan Primer		APRIL.2022	Waterbase Floor Coating
				Sunitan Top Coat		APRIL.2022	Waterbase Floor Coating
				Unipoxy Lining	3T	APRIL.2022	Epoxy Self Leveling
				Unipoxy Resin Motar	3T	APRIL.2022	Epoxy Resin Motar

# ■ USDA CERTIFICATION

The **USDA Certified Biobased Product label** is designed to provide useful information to consumers about the biobased content of the product. The label assures a consumer that the product contains a USDA-verified amount of renewable biological ingredients



TYPE	APPLICATION	PRODUCT NAME	BIO CARBON %	CERTIFICATION DATE
DECORATIVE	INTERIOR WALL COATING	SUPRO NATURE	USDA, Bio 41%	JUL. 2022
DECORATIVE	WATERPROOFING COATING	SPORTHANE EXPOSURE WATERPROOFING COAT(BIO)	USDA, Bio 33%	JUL. 2022
DECORATIVE	STEEL COATING	ROYAL ENAMEL	USDA, Bio 26%	APRIL. 2023
DECORATIVE	WOOD COATING	ROYAL WOOD	USDA, Bio 31%	APRIL. 2023
DECORATIVE	FLOOR COATING	UNIPOXY LINING(BIO)	USDA, Bio 37%	APRIL. 2023
DECORATIVE	FLOOR COATING	SPORTHANE HIGH HARD COAT(BIO)	USDA, Bio 51%	APRIL. 2023



KCC paint  
FLOOR COATING

# KCC FLOOR COATING

The clean environment comes from the clean floor.  
Create pure and pleasant atmosphere with the clean floor.

# Epoxy Anti-dust Floor Coating

UNIPOXY COATING, UNIPOXY LINING

**KCC Unipoxy floor coating** is high performance finishing that is designed to prevent dust generated from impact or abrasion on the cement mortar by creating tough film with anti-chemical properties (water resistance, acid resistance, alkali resistance, and etc.) as well as anti-static properties using combinations of high molecule epoxy.

Especially, Unipoxy Lining is non-solvent type and self-leveling coating, it's environment-friendly with mechanical property and beautiful exterior.



## Application

- Parking lot in building
- Hospital, GMP facilities for pharmaceutical Co., precision apparatus factory, computer room, Semiconductor factory, examine room, and laboratory
- Food processing factory, meat processing factory, and floor of cold warehouse
- Chemical factory, and floor of factories that handles dust
- Machinery room, control room, battery room, and warehouse

## Characteristics

### 1) COATING (Thin film type)

- High Anti-abrasion, Anti-chemical, Anti-pollution property
- Great adhesiveness on substrates
  - It has extra adhesiveness on substrate because the epoxy primer permeates into concrete or mortar surface.
- Beautiful exterior and various of different colors can be chosen.

### 2) LINING (Thick film type)

- High quality of Anti-chemical, Solvent resistance, Scratch resistance
- Tough on impact
  - Tough on impact
  - Easy thickness adjustment. (2~3 mm)
- Environment friendly
  - It does not contain solvent and able to correspond with VOC regulation

## Coating Specification

### 1) Coating

Coating Classification	Product Name	Film thickness (μm)	Theoretical Required Amount		Coating Method	Remarks
			m <sup>2</sup> /L	L/m <sup>2</sup>		
Primer	Unipoxy Primer 100	50	5.6	0.18	B, R, S	Strengthen substrate & adhesiveness
Topcoat	Unipoxy Coating	50	5.5	0.18	B, R, S	Excellent abrasion-resistance, chemical resistance

※ B : Brush, R : Roller, S : Spray

### 2) Lining

Coating Classification	Product Name	Film thickness (μm)	Theoretical Required Amount		Coating Method	Remarks
			m <sup>2</sup> /L	L/m <sup>2</sup>		
Primer	Unipoxy Primer 100	50	5.6	0.18	B, R, S	Strengthen substrate & adhesiveness
Topcoat	Unipoxy Lining	2,000 ~ 3,000	0.32 ~ 0.97	1.03 ~ 3.09	Rake, Hera	Excellent abrasion-resistance, mechanical property

※ Unipoxy Lining requires pre-coat for 0.5 ~ 0.8 mm of thickness to prevent substrate contamination and bubbles caused by holes on substrate.

※ B : Brush, R : Roller, S : Spray

# ■ AGV(Auto Guided Vehicle) Floor Coating

## Lightweight AGV Operating Area

### ■ AGV(Auto Guided Vehicle) Operating Area (HMGMA-Hyundai Motor, GA : Welding, Assembly Building)

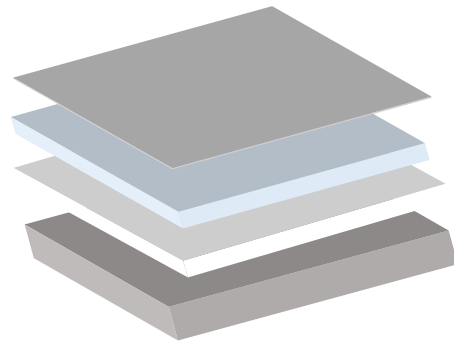

Total Paint Film Thickness : 3.00mm

- 3<sup>rd</sup> : **Unipoxy(Hybrid)- Antistatic** 50 $\mu$ m \* 2 Coat
- 2<sup>nd</sup> : Unipoxy Lining 2,800 $\mu$ m \* 1 Coat (500  $\mu$ m + 2300 $\mu$ m)
- 1<sup>st</sup> : Supro Solvent Free Primer(TR) 100 $\mu$ m \* 1 Coat
- Concrete



### ■ AGV(Auto Guided Vehicle) Non-operating Area (HMGMA-Hyundai Motor, GA : Paint Building)

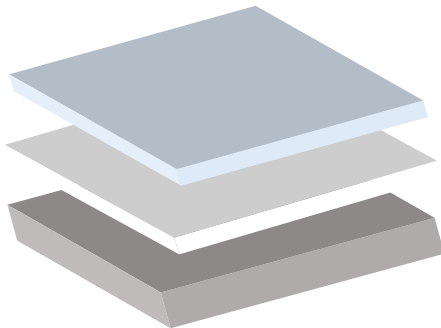

Total Paint Film Thickness : 3.00mm

- 2<sup>nd</sup> : Unipoxy Lining 2,800 $\mu$ m \* 1 Coat (500  $\mu$ m + 2300 $\mu$ m)
- 1<sup>st</sup> : Supro Solvent Free Primer(TR) 100 $\mu$ m \* 1 Coat
- Concrete

Hyundai Motor Factory, Savannah GA

Epoxy Floor Coating Area: 3,400,000SF

Epoxy Paint Value : USD4,000,000

# Anti-static Floor Coating

UNIPOXY ANTISTACTIC

Unipoxy Antistatic prevents possible accidents and obstacles such as electric shock condition that is caused by electrification, static and electric discharge, unpleasant feeling and fear from working near inflammables, explosives which leads to lack of work efficiency. Also it avoids damages of semi-conductors caused by electric discharge and dust adhesion on walls and ceilings.



## Application

- Factories for electrics, electricity, computers, and electric parts
- A place where they handle inflammable gas and organic solvent
- A place where it requires high dust resistance such as clean room, aseptic room, operating room, and so on

## Characteristics

- **High degree of functionality**
  - By high anti-static effect, prevents fire from electric discharges.
  - Surface resistivity is  $1 \times 10^6 \Omega \sim 9 \times 10^8 \Omega$  and applicable for clean room class 100.
  - Mainly consists of epoxy, it has high chemical resistance, abrasion resistance, adhesiveness, water resistance and impact resistance.
- **Operation and economic efficiency**
  - Coating operation can be simply done with spray, rake and roller, and recoating is easily possible as well so it is quite easy to maintain and keep its anti-static property semi-permanently.
  - ※ The thickness of the film can be adjusted depends on circumstances and it also cuts off expenses.

## Coating Specification

Coating Classification	Product Name	Film thickness ( $\mu\text{m}$ )	Theoretical Required Amount		Coating Method	Remarks
			$\text{m}^2/\text{L}$	$\text{L}/\text{m}^2$		
Primer	Unipoxy Primer 100	50	5.6	0.18	B, R, S	Primer to intensify substrate and improve adhesiveness
Midcoat	Unipoxy Lining	2,000 ~ 3,000	0.33 ~ 0.98	1.02 ~ 3.06	Rake, Hera	Great chemical-resistance, Mechanical property, noise control and shock-resistance
Topcoat	Unipoxy Antistatic	50	4.8	0.21	B, R, S	High function of Adhesiveness, abrasion resistance and anti-static property

※ B : Brush, R : Roller, S : Spray

# Chemical Resistance Epoxy Floor Coating

## UNIPOXY CHEMICAL RESISTANCE

**Unipoxy Chemical Resistance** has great mechanical properties of solvent-free epoxy floor coating and self-levelling, it has strong chemical resistance to sulfuric acid, phosphoric acid, nitric acid, hydrochloric acid, NaOH and so on. Also it prevents problems such as discoloration caused by chemicals, blister, flaking, etc.



## Application

- Finishing floor for hospitals, pharmaceutical firms
- Finishing floor for food factories, chemical factories that handles acid
- Finishing floor for chemical laboratories, school science lab

## Characteristics

- **Excellent Acid-resistance**
  - It has great acid-resistance compared with normal epoxy floor coating.
- **Great Chemical-resistance**
  - Acid-resistance, alkali-resistance, oil-resistance.
- **High mechanical properties.**
  - Tensile strength, compression strength which is identical with solvent-free epoxy floor coating, it can be used in plants loading.

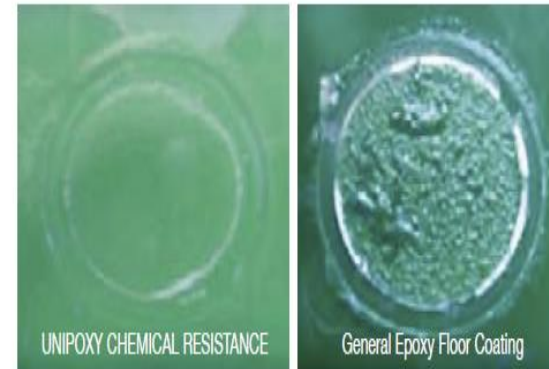

Condition after immersion for 24 hours  
50% H<sub>2</sub>SO<sub>4</sub>

## Coating Specification

Coating Classification	Product Name	Film thickness (μm)	Theoretical Required Amount		Coating Method	Remarks
			m <sup>2</sup> /L	L/m <sup>2</sup>		
Primer	Unipoxy Primer 100	50	5.6	0.18	B, R, S	Primer to intensify substrate and improve adhesiveness
Topcoat	Unipoxy Chemical Resistance	2,000 ~ 3,000	0.3 ~ 0.4	2.04 ~ 3.06	B, R, S	Finishing coating for both midcoat and topcoat, which has great chemical resistance, mechanical properties and wear resistance

※ B : Brush, R : Roller, S : Spray

# Decorative Epoxy Floor Coating

## UNIPOXY MARBLE

Unipoxy Marble has great mechanical properties of high resistance to heavy abrasion and impact, it is mainly solvent-free lower yellowing epoxy resin based without concern for discoloration. It is possible to make a unique interior effect using 16 colors pearl powder and a beautiful appearance with self-levelling.



Epoxy Coating

## Application

- Finishing floor for hotels, department stores, shops
- Finishing floor for indoor places that require feel of natural marble

## Characteristics

- **Gorgeous appearance**
  - It has a beautiful appearance with natural marble texture and self-levelling property.
- **Creating unique interior**
  - Choose 16 colors pearl powder that KCC recommends and make various patterns.
- **High mechanical properties.**
  - High tensile strength, compression strength and solvent-free properties.



Silver Gray & Luster Blue Pearl



Red Brown & Royal Gold Pearl

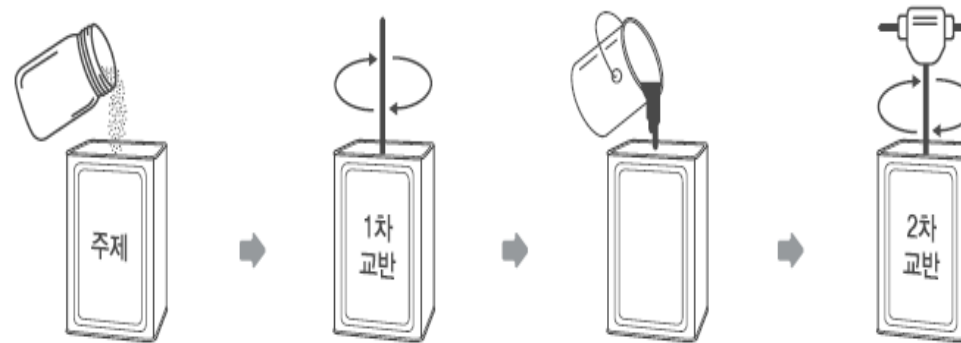

Color Pearl + Unipoxy Marble PTA

(Color Pearl + PTA) + PTB

# Decorative Epoxy Floor Coating

## UNIPOXY MARBLE



라이트 옐로우  
Light Yellow



골드 펄  
Gold Pearl



로얄 골드  
Royal Gold



글리터 골드  
Glitter Gold



쉬머 펄  
Shimmer Pearl



핑크 실버  
Pink Silver



레드 브라운  
Red Brown



와인 레드  
Wine Red



글리터 블루  
Glitter Blue



옐로쉬 그린  
Yellowish Green



러스터 블루  
Luster Blue



바이올렛  
Violet



루틸 실버  
Rutile Silver Fine Satin



실버 펄  
Silver Pearl



실버 그레이  
Silver Gray



실버 블랙  
Silver Black

# Urethane Anti-Dust Floor Coating

SPORTHANE

**KCC Sporthane Anti-Dust Floor Coating** has high performance finishing that is designed to prevent dust generated from impact or abrasion on cement mortar by creating tough film with anti-chemical.

Also it is elastic and easy in walking using combinations of high molecule polyurethane, forming solid coatings.



## Application

- Parking lot in building
- Hospital, GMP facilities for pharmaceutical Co., precision apparatus factory, computer room, semiconductor factory, examine room, and laboratory
- School, office, library and etc.
- Machinery room, control room, battery room, and warehouse

## Characteristics

- **Good elasticity and ease in walking**
  - It has good function of elasticity, helps that walking is more convenient.
- **Great anti-abrasion**
  - Excellent anti-abrasion after hardening as it's a two-component, chemical reaction hardening type.
- **High Chemical-resistance**
  - It has great water-resistance, acid-resistance, alkali-resistance and oil-resistance.
- **Good elasticity and ease in walking**
  - It has good function of elasticity, helps that walking is
- **Good function of anti-pollution**
  - It is easy to remove when the surface is contaminated by dust, oil, chemicals and etc. after top coating.
- **Non-Slip function**
  - At finishing, it can be used for non-slip function, depending on coating method such as spattering, spraying silica sand and so on.
- **Beautiful exterior and various colors can be chosen.**
  - It's self-levelling urethane, filling up a bumpy surface and finishing beautifully. Also there are lots of color to be chosen considering innards and surrounding.

## Physical property by Coating specification

Product Name			Urethane Thin film			Remarks
Coating Specification			Sporthane High Hard Layer Topcoat			
			Sporthane KS Hyper Floor & High Hard Layer Midcoat			
			Sporthane Primer			
Water resistance	Appearance		GOOD	GOOD	GOOD	Deposited in clear water in 8 days
	Change of weigh		0.06	0.3	0.1	Deposited in clear water in 8 days
Light resistance	Appearance		GOOD	GOOD	GOOD	UV Tester (in 8days)
	Change of Gloss	Initial stage	83	83	83	60 °C Gloss
		After test	83	83	83	UV Tester

# Urethane Anti-Dust Floor Coating

## SPORTHANE

### Coating Specification

#### 1) Urethane High-Intensified Floor Coating : Sporthane High Hard Layer

Coating Classification	Product Name	Film thickness (μm)	No. of Coating	Theoretical Required Amount (kg/m <sup>2</sup> )	Coating Method	Remarks
Primer	Sporthane Primer	50	1	0.14	B, R, S	Primer to intensify substrate and improve adhesiveness
Sealer	Sporthane High Hard Layer (Sealer)	500	2	0.8	Rake, Hera	Sealer to enhance the adhesion of subsequent coat
Midcoat	Sporthane High Hard Layer Midcoat	2,000 ~ 3,000	3	2.6 ~ 3.9	Rake, Hera	All-weather elastic floor coating which has great adhesion and mechanical properties
Topcoat	Sporthane High Hard Layer Topcoat	50	4	0.20	B, R, S	Excellent durability, chemical resistance and weatherability

※ B : Brush, R : Roller, S : Spray

#### 2) Urethane High-Intensified Floor & Waterproofing Coating : Sporthane KS Hyper Floor

Coating Classification	Product Name	Film thickness (μm)	No. of Coating	Theoretical Required Amount (kg/m <sup>2</sup> )	Coating Method	Remarks
Primer	Sporthane Primer	50	1	0.14	B, R, S	Primer to intensify substrate and improve adhesiveness
Sealer	Sporthane High Hard Layer (Sealer)	500	2	0.8	Rake, Hera	Sealer to enhance the adhesion of subsequent coat
Midcoat	Sporthane KS Hyper Floor	2,000 ~ 3,000	3	2.9 ~ 4.37	Rake, Hera	Meeting both the Korean Standard KS F 3211 & KS F 4937
Topcoat	Sporthane High Hard Layer Topcoat	50	4	0.20	B, R, S	Excellent durability, chemical resistance and weatherability

※ B : Brush, R : Roller, S : Spray

※ KS F 3211 : Waterproofing membrane coating for construction

※ KS F 4937 : Surface finishing material for parking slab



Sporthane KS Hyper Floor applied in an underground parking lot

# Urethane Floor Coating For Outdoor Parking Lot

This specification is the operational method of urethane floor coating to complement light weighted steel frame structured parking lot. It does not require concrete application which gives light weighted parking lot and cuts operational cost. Also it has high adhesiveness on the substrate and high crack resistance against vibration.



## Application

- Outdoor parking lot
- Parking lot that requires light weighted frame

## Characteristics

- Applicable on the steel surface.
- Light weighted steel-frame structure makes possible to operate on weak ground.
- Its high weatherability makes outdoor application possible.
- High crack resistance against vibration of metal parking lot.
- Combined use of waterproof.
- Non-slip operation can be done.

## Construction Cross Section

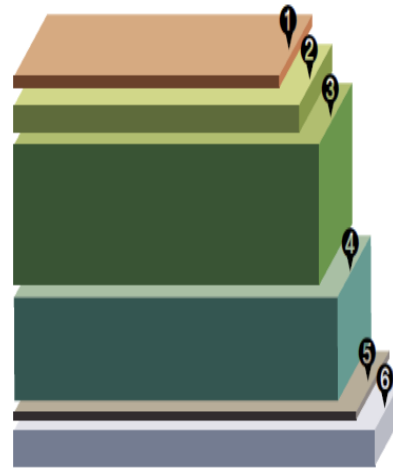

	Name	Film Thickness
1	Sporthane High Hard Layer Topcoat	100 $\mu\text{m}$
2	Sporthane High Hard Layer Midcoat	500 $\mu\text{m}$
	SAND Spray	4-5 SAND
3	Sporthane KS Hyper Floor	2,000 ~ 3,000 $\mu\text{m}$
3	Sporthane High Hard Layer Midcoat	2,000 ~ 3,000 $\mu\text{m}$
4	Sporthane Waterproofing Coat KS Class 1	2,000 $\mu\text{m}$
5	For cement, concrete : Sporthane Primer For steel : EP1730	50 $\mu\text{m}$
6	Cement / Concrete / Steel plate	

# KCC URETHANE WATERPROOFING

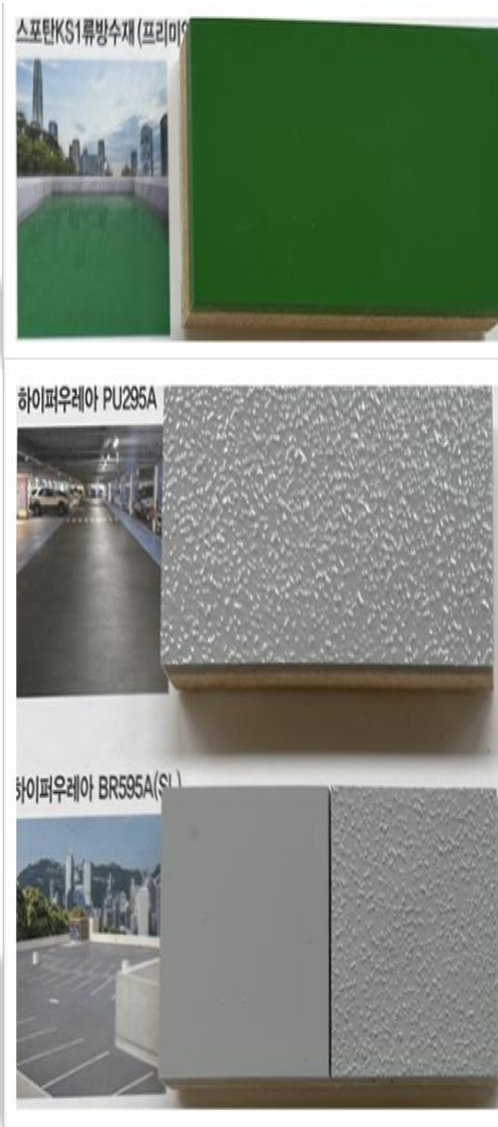

스포탄 KS1류방수재(프리미엄)  
스포탄 노출방수재(3,000 $\mu$ m)

도장구분	제품명	도막두께( $\mu$ m)	도장방법	색상	비고
하도	스포탄하도	50	B, R, S	투명	소지 보강 및 부착성 향상을 위한 프라이머
중도	스포탄KS1류방수재 (프리미엄) or 스포탄노출방수재	500+2,500 = 3,000	Rake	화색 or 기타	신율이 탁월하고 마모나 충격의 견딤성이 우수한 방수재
상도	스포탄상도	50	B, R, S		내후성, 내마모성 등이 우수한 2액형 방수 마감재



# Polyurea Waterproof Floor Coating

HYPERUREA

**Hyperurea** is created by causing a chain reaction of Isocyanate Prepolymer and Polyamin, it's curing time for hardeness is very short so that it can be applied on low temperature and high humidity without catalysts. Also it shortens construction time by making film very quickly and it is possible to repair fast on bustling street.

## Application

- Waterproof floor coating for exposed part of concrete structures (parking lot, rooftop and etc.)
- Waterproofing for waterlogging part (tank, sewage treatment plant, filtration plant, swimming pool, cooling pool and so on.)
- Concrete waterproofing with heat insulation part (cold storage, ice storage tank and etc.)
- Concrete underground embedded part
- Steel frame structured parking lot

## Characteristics

- **Velocity hardening type**
  - Continuing dry : within 30 sec.
  - Hardening dry : within 60 mins.
- **Great properties**
  - Tensile strength, tearing strength, shock resistance, elasticity, bond strength.
- **Excellent waterproofing/chemical resistance**
  - It can be applied to places required waterproofing, chemical resistance such as pharmaceutical factory and food factory.
- **Eco-friendly paint**
  - Solvent-free, VOCs Free type, it's harmless to human body.
- **Excellent workability**
  - Possible to work in a short period of time and easy to apply to slope and vertical plane.
- **It is very economical**
  - Hyperurea has a wide choice of selections such as pure urea (PU295A, BR595A) which has best properties as well as economical hybrid urea (HB195, Hyperurea for FLOORING).



Polyurea Floor Coating



Rooftop waterproof coating



Singapore SLNG Tank



Water treatment equipment

Tank (fresh water tank), Swimming pool, Water waste disposal facilities.



Truck Bed Lining

# Polyurea Waterproof Floor Coating

## HYPERUREA

### Coating specification

#### 1) Floor coating for parking lot(Concrete) and roof waterproofing coating

Coating Classification	Product Name	Film thickness (μm)	Coating Method	Color	Remarks
Primer	Sporthane Primer	50	B, R, S	Clear	Primer to intensify substrate and improve adhesiveness
Midcoat 1	Sporthane High Hard Layer Midcoat	500	Rake	Grey, Green or Etc.	High abrasion resistance & Increase rate
Midcoat 2	Choose one : Hyperurea PU295A, HB195A	2,000 ~ 3,000	Coating Machine for Polyurea		Great mechanical properties and elongation
Topcoat	Sporthane High Hard Layer Topcoat (Exterior)	50	B, R, S		Excellent abrasion resistance and weatherability

※ B : Brush, R : Roller, S : Spray

#### 2) Room temperature & Self-levelling type waterproofing coating

Coating Classification	Product Name	Film thickness (μm)	Coating Method	Color	Remarks
Primer	Sporthane Primer	50	B, R, S	Clear	Primer to intensify substrate and improve adhesiveness
Midcoat	Hyperurea BR595A(SL)	2,000 ~ 3,000	Coating Machine for Low temperature and Self-levelling	Grey, Green or Etc.	Room temperature type, great mechanical properties
Topcoat	Sporthane High Hard Layer Topcoat (Exterior)	50	B, R, S	Grey, Green or Etc.	Excellent abrasion resistance and weatherability

※ B : Brush, R : Roller, S : Spray

#### 3) Steel frame floor coat

Coating Classification	Product Name	Film thickness (μm)	Coating Method	Color	Remarks
Primer	Multipurpose Primer EP1730	50	B, R, S	Clear	Primer to intensify substrate and improve adhesiveness
Midcoat 1	Sporthane High Hard Layer Midcoat	500	Rake	Grey, Green or Etc.	High abrasion resistance & mechanical properties
Midcoat 2	Choose between Hyperurea PU295A HB195A, BR595A	2,000 ~ 3,000	Coating Machine for Polyurea		Great mechanical properties and elongation
Topcoat	Sporthane High Hard Layer Topcoat (Exterior)	50	B, R, S		Excellent abrasion resistance and weatherability

#### 4) Tank

Coating Classification	Product Name	Film thickness (μm)	Coating Method	Color	Remarks
Primer	Sporthane Primer	50	B, R, S	Clear	Primer to intensify substrate and improve adhesiveness
Midcoat 1	Sporthane High Hard Layer Midcoat	500	Rake	Grey, Green or Etc.	High abrasion resistance & mechanical properties
Midcoat 2	Hyperurea PU295A	2,000 ~ 3,000	Coating Machine for Polyurea		Great mechanical properties and elongation
Topcoat	Sporthane High Hard Layer Topcoat (Exterior)	50	B, R, S		Excellent abrasion resistance and weatherability

※ B : Brush, R : Roller, S : Spray

### Coating Machine for Hyperurea

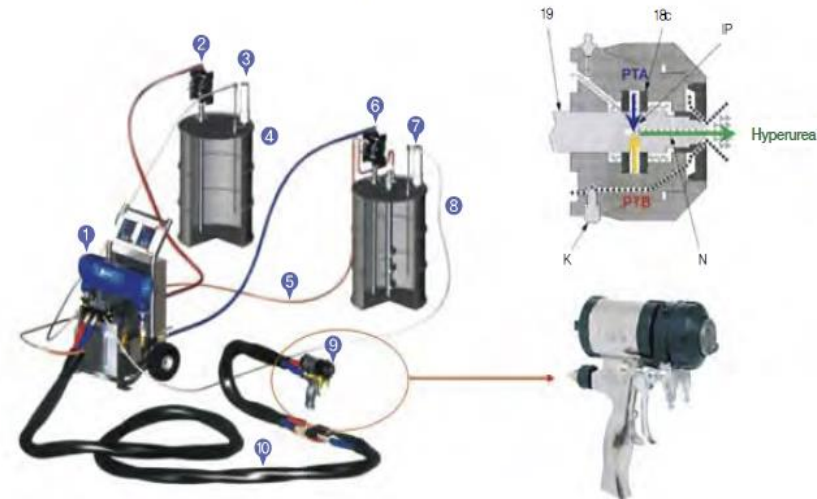

- ① Coating Machine Main Body
- ② A part moving pump
- ③ Dehumidifier
- ④ A part (ISO.)
- ⑤ Gun hose
- ⑥ B part moving pump
- ⑦ Dehumidifier
- ⑧ B part
- ⑨ 2K cross mixing Spray gun
- ⑩ Heating Hose for High temperature and high pressure

Unlike general Airless spray, Base(PTA) and Curing agent(PTB) join at coating gun, crossed mixing under the high temperature and high pressure.  
(Pressure condition : more than 2,000 psi, Temperature condition : more than 70 °C)

# KCC Crete Floor Coating

**KCC Crete Floor Coating** is three-component polyurethane resin screed that is designed in area where heavy equipments are passing frequently and area where organic acids, alkalis, strong corrosive chemicals are frequently exposed.

## Application

- Food factories, cafeterias, kitchens.
- Refrigeration warehouses, normal warehouses.
- chemical factories, pharmaceutical factories.
- Types of floors for various facilities.

## Characteristics

- High durability : High hardness and compressive strength for long-term durability against huge impact.
- Excellent chemical resistance : keep the surface clean and not deformed even in contact with moisture and chemicals.
- Excellent workability : Pedestrian passable after 12 hours of application

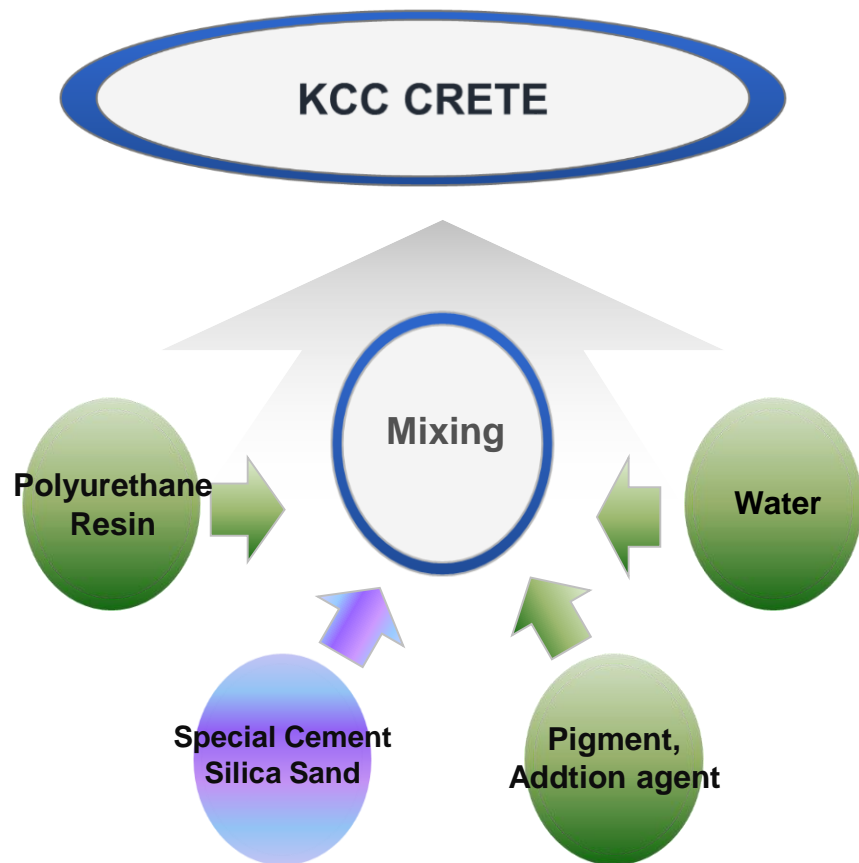

Pharmaceutical Facilities

# KCC Crete Floor Coating

Type	KCC Brand	Thickness	Application	Surface Finish
Concrete Floor	KCC CRETE	4 ~ 6 mm	Squeeze	Smooth Surface or Non Slip Surface
Cold Storage High Temperature	KCC CRETE (Plaster)	6 ~ 10 mm	Trowel	Rough Surface
Vertical Area Skirting Board	KCC CRETE (Vertical)	4 ~ 9 mm	Special Plaster work	Rough Surface
Thin Coating	KCC CRETE Thin Coat	0.2 ~ 0.4 mm	Roller	Depend on base concrete texture

**Concrete**  
**(Physical Properties)**

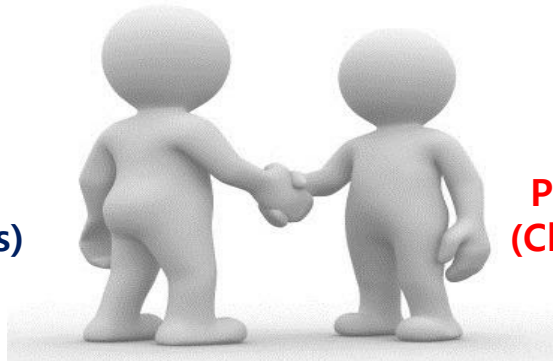

**Polyurethane Resin**  
**(Chemical Properties)**



**Chemical Resistance, Water Resistance**  
**Temperature Resistance**



# ■ KCC HARD FLOOR(Liquid Hardener of Sodium Type)

KCC Hard floor is chemically reative concrete sealer, hardener, And dust proofer.  
This reaction chamically hardenes the concrete surface, rendering it Abration resistance, dust free and resistant to the penetration Of Surface contamination.

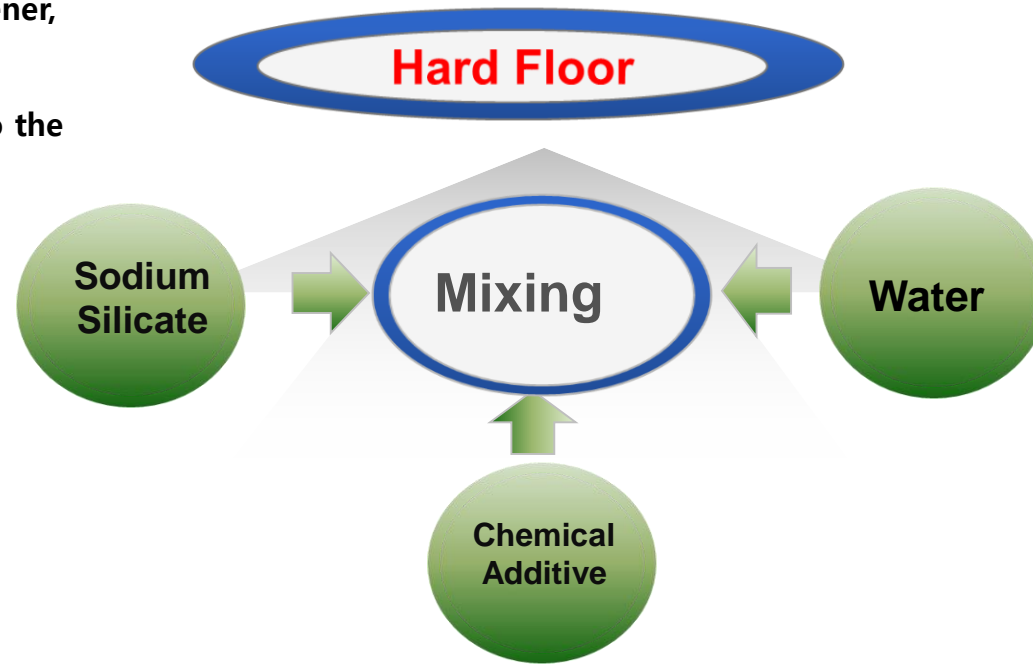

< Concrete Hardening Procedure >



< Concrete Polishing Procedure >

# ■ HPP(High Performance Poymer) PVC TILE

## Industrial / Commercial Flooring Solutions



Heavyweight AGV Operating Area

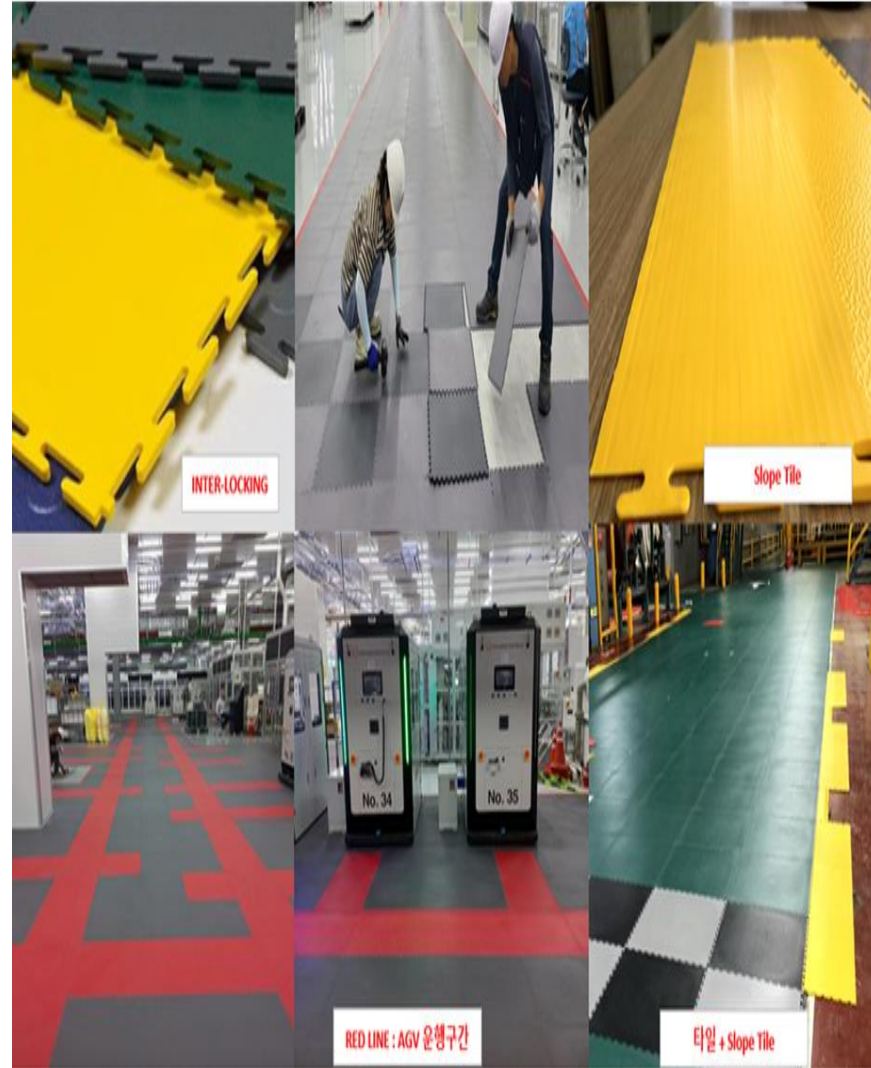

# ■ HPP(High Performance Poymer) PVC TILE

## [ Products ]

두께 [5mm]	〃ET-5005 / FT-5004 / FTE-5004 / FT-50045 / FTE-50045 / FTH-4605 〃500mm × 500mm × 5mm	
두께 [7mm]	〃ET-5007 / ETE-5007 / FT-5007 / FTE-5007 / FTH-5007 / FTHE-5007 〃500mm × 500mm × 7mm	
두께 [10mm]	〃ET-50010 / FT-50010 〃500mm × 500mm × 10mm	

## [ Application Procedure ]

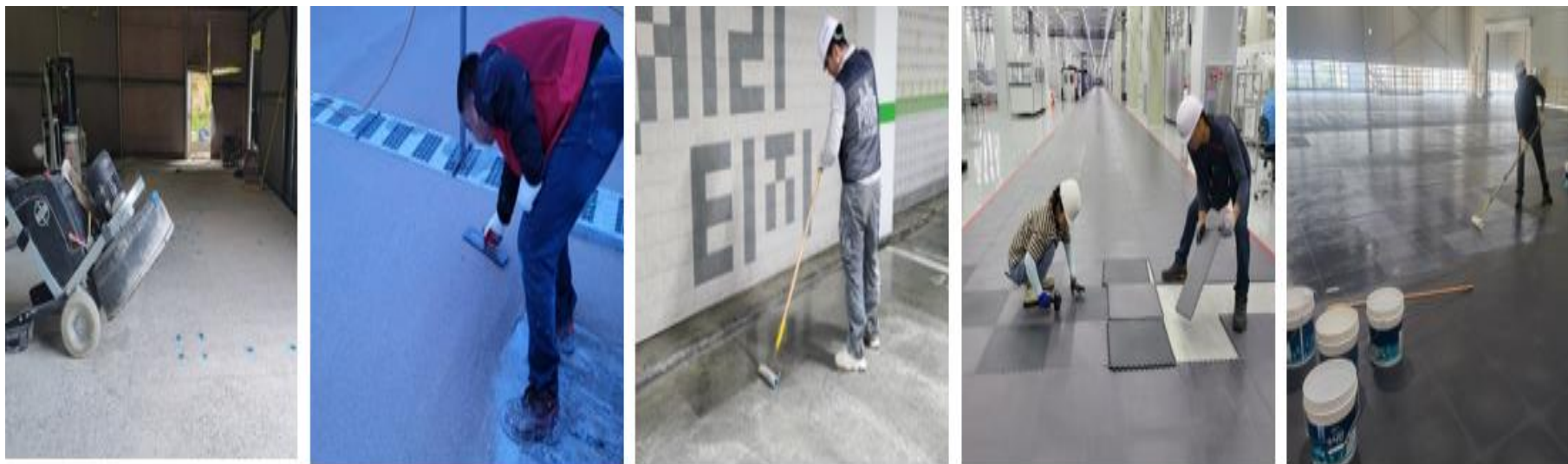

# ■ HPP(High Performance Poymer) PVC TILE

---

[ HANKOOK TIRE, 7mm ]

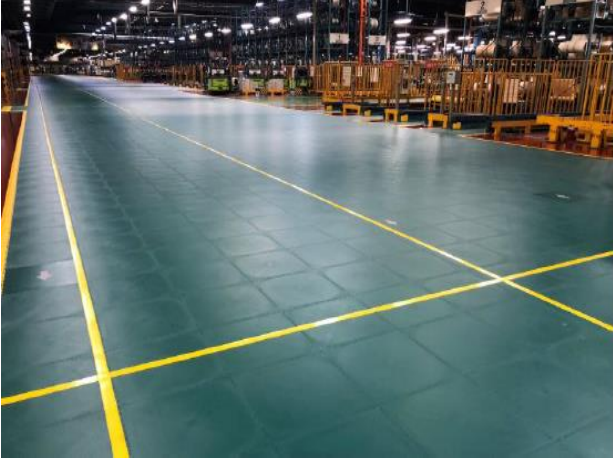

[ HANWHA Q CELLS, 7mm ]



[ KT&G, 7mm ]



[ KIA MOTOR Q-CENTER WORKSHOP ]

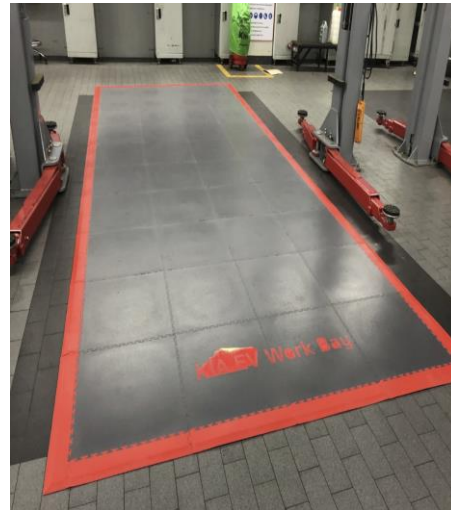
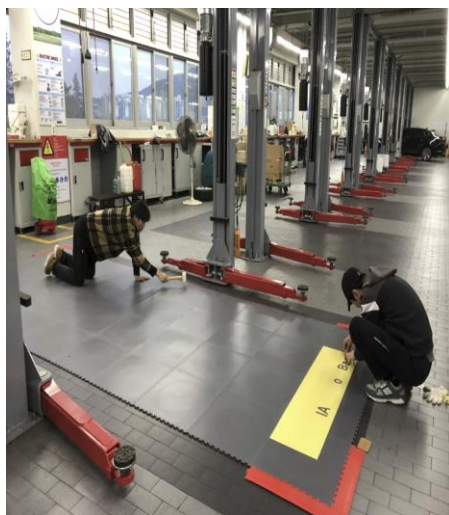

[ PPG KOREA, 7mm ]



THE ABOUT

# Interior / Exterior Material

KCC's interior and exterior materials  
make it possible for you to have a  
pleasant and relaxing day, every day.

## CEILING MATERIAL

Mineral Fiber Acoustic Ceiling Board

## GYPSUM BOARD

## INSULATION MATERIAL

Glass Wool

Mineral Wool

## FLOORING MATERIAL

PVC Flooring



Super-Fire-Resistant and Acoustic  
Ceiling Board

## KCC MITONE

KCC MITONE is a high-quality acoustic ceiling board made from natural mineral wool.

The weight of KCC MITONE is only one-third that of other conventional gypsum cement boards. It can also be produced as a broad board with a variety of patterns, making the ceilings of buildings beautiful and elegant. Along with various types of construction systems, such as the T&H-BAR, M-BAR, T-BAR, and PYRAMODULE systems, it ensures a unique style of space decoration.

Thus, aside from creating a quiet and comfortable space and mood by absorbing and blocking indoor and outdoor noise, KCC can also add beauty and convenience to the ceilings of a range of buildings, including offices, hospitals, hotels, and shopping malls.



High Quality Acoustic ceiling board

# KCC MITONE

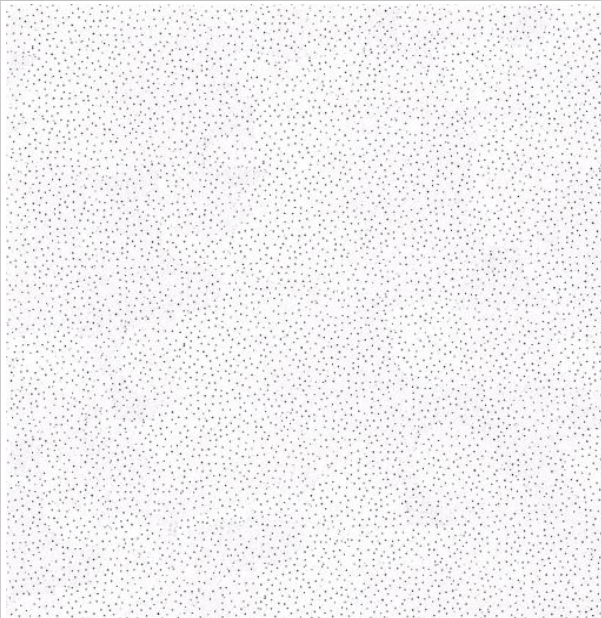
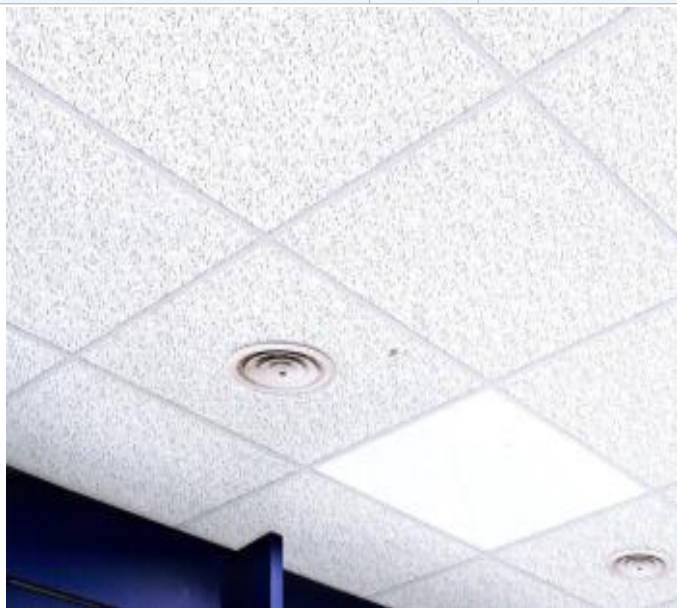
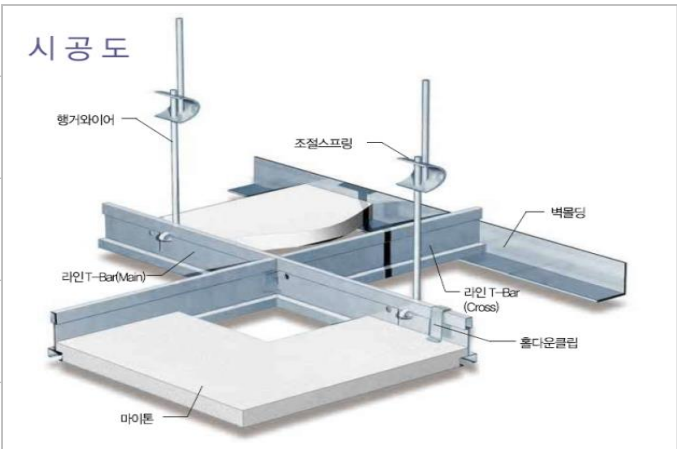

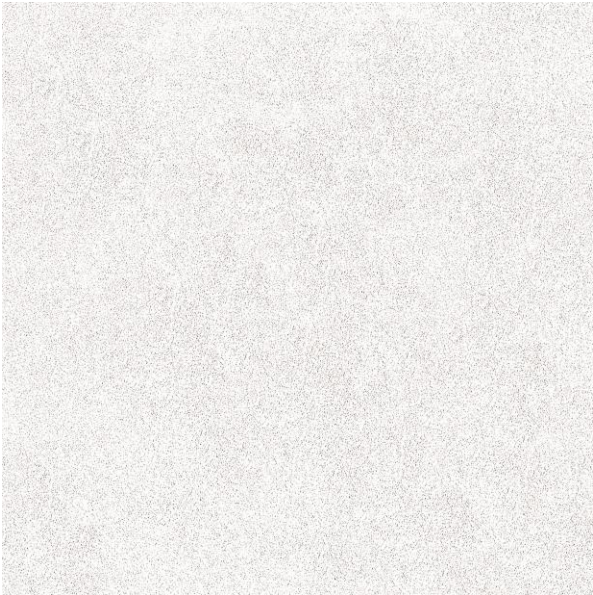

1	CEILING BOARD	DATE	2023.01.25	1	T-BAR SYSTEM	DATE	2023.1.25
PHOTO				PHOTO			
CODE	MITONE Fine Point (MT610) / Edge coating						
CHARACTERISTICS	High-quality Acoustic ceiling board						
STANDARD	MT Fine Point 15T 594 * 594						
MANUFACTURER	KCC Corporation						
Remark	Hyundai Mobil & LG Battery Factory Indonesia DEC 2020-MAY 2023						

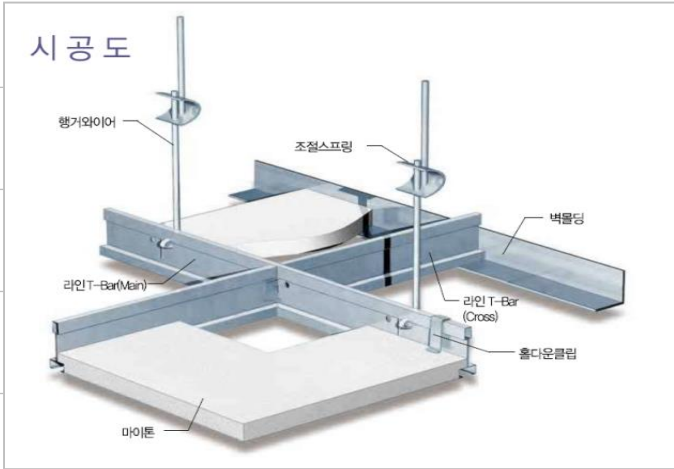

■ KCC ACOUSTIC CEILING BOARD (LEED CERTIFICATION)

1	CEILING	DATE	2023.01.25	1	T-BAR SYSTEM	DATE	2023.1.25
PHOTO				PHOTO			
CODE	MITONE CLOUDIA(MCD900)						
FEATURES	High-quality Acoustic ceiling board						
STANDARD	MCD900 (15T 603 * 603mm)						
MANUFACTURER	KCC Corporation						
Remark							

3	GLASS WOOL	DATE	2023.1.25	3	GLASS WOOL	DATE	2023.1.25
PHOTO				PHOTO			
CODE	KCC Glass Wool Nature			CODE	KCC Glass Wool Clean Panel		
STANDARD	24K, 32K, 40K, 48K, 64K, 80K, 96K 25T ~ 120T			STANDARD	48K, 64K, 74K		
PACKAGE	열전도율: 0.035(24K), 0.033 (48K)			PACKAGE	열전도율: 0.034(48K), 0.033 (64, 74K)		
MANUFACTURER	KCC Glass Corporation			MANUFACTURER	KCC Glass Corporation		
Remark				Remark	Hyundai Mobil & LG Battery Factory Indonesia DEC 2020-MAY 2023		

3	PVC TILE	DATE	2023.1.25	3	SEALANT	DATE	2023.1.25
PHOTO				PHOTO			
CODE	DX3603C			CODE	DX3609C		
STANDARD	3mm(T) x 300mm x 300mm			STANDARD	3mm(T) x 300mm x 300mm		
PACKAGE	37pcs/Box			PACKAGE	37pcs/Box		
MANUFACTURER	KCC GLASS CORPORATION			MANUFACTURER	KCC GLASS CORPORATION		
Remark	Hyundai Motor & LG Battery Factory Indonesia DEC 2020-MAY 2023 Office room			Reference	Hyundai Motor & LG Battery Factory Indonesia DEC 2020-MAY 2023 Praying room etc		

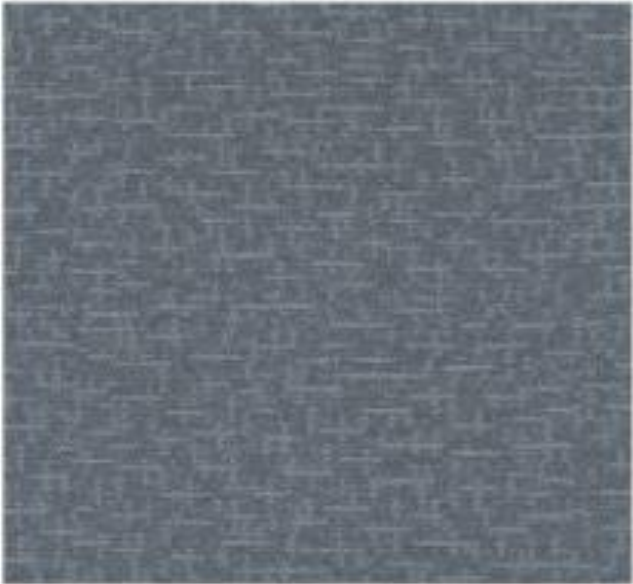
# KCC PVC VINYL TILE / SEALANT

3	PVC TILE	DATE	2023.1.25	3	SEALANT	DATE	2023.1.25
PHOTO				PHOTO			
CODE	SENDRTILE GS1557M (Carpet Texture)			CODE	SL907		
STANDARD	3mm(T) x 600mm x 600mm			STANDARD	300ml Cartridge		
PACKAGE	9pcs / Box			PACKAGE	20ctg/1box		
MANUFACTURER	KCC Glass Corporation			MANUFACTURER	KCC Corporation		
Remark	Meeting room Project : Hyundai Motor Manufacture Indonesia DEC 2020-NOV 2021			Reference	Window Profile & Wall Panel Joint Project : Hyundai Motor Manufacture Indonesia		

KCC BEAUTICLE

# BEAUTICLE



## 뷰티클

또 하나의 생활공간이자 문화공간인 화장실에 아름다움을 더하여 친환경 웰빙 라이프를 꿈꾸는 현대인들에게 편안함과 이득함, 쾌적함을 제공하고자 합니다.



# KCC TOILET PARTITION

/00

2	TOILET PARTITION	DATE	2023.1.25
PHOTO	 <p>Post Door</p> <p>NEO POP ST Hardware</p> 		
CODE	BEAUTICLE NEO POP ST		
STANDARD	T20 Partition		
LOCATION	TOILET Partition		
MANUFACTURER	BS683-1/Door + BS683/Post + Silver Sus / 걸레받이		
Size	Post: 2700mm, Door & Partition: 2000mm		

2	TOILET PARTITION	DATE	2023.1.25
PHOTO			
Reference	Hyundai Motor Factory Indonesia DEC 2020-MAY 2023		

# PROJECT REFERENCE – SK GROUP

SK NEXILIS, MALAYSIA / SK-ON EV BATTERY, HUNGARY /  
SK NEXILIS, POLAND

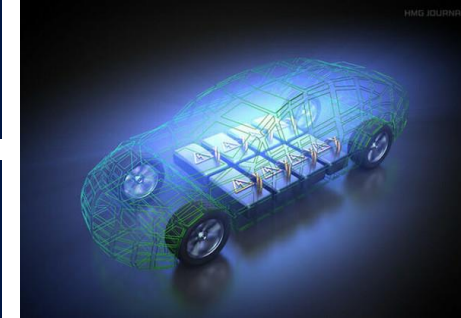

## ◆ SK NEXILIS Malaysia Copper Foil Factory #1, #2

1. Location: Kuching Sarawak, Malaysia
2. Production capacity: 100,000ton
3. Capex: U\$589million
4. Operation date: January 2023
5. Area: 281,084m<sup>2</sup>
6. KCC Supplied:  
Protective Coatings, Epoxy Flooring  
Fire Proofing



## ◆ SK ON Hungary Factory

1. Location: Komarom, Hungary
2. Production capacity: 7.5GWh
3. Capex: U\$859million
4. Operation date: January 2022
5. Area: 117,130m<sup>2</sup>
6. KCC Supplied:  
Protective Coatings,  
Epoxy Flooring



## ◆ SK NEXILIS Poland Copper Foil Factory

1. Location: Warszawa, Poland
2. Production capacity: 150,000ton
3. Capex: U\$963million
4. Operation date: January 2024
5. Area: 560,817m<sup>2</sup>
6. KCC Supplied:  
Protective Coatings,  
Epoxy Flooring  
Fire Proofing

# PROJECT REFERENCE – INDONESIA

## HYUNDAI MOTOR / LG ENSOL EV BATTERY / LOTTE CHEMICAL- LINE



### ◆ Hyundai Motor Manufacturing Indonesia

1. Location: Deltamas industrial town
2. Production capacity: 150,000units
3. Capex: U\$1.55billion
4. Operation date: January 2022
5. Area: 793,388m<sup>2</sup>
6. KCC Supplied:  
Protective Coatings, Epoxy Flooring,  
Coil Coatings, Ceiling Board, Toilet Partition, PVC Tile



### ◆ LG ENSOL Indonesia

1. Location: Karawang, Indonesia
2. Production capacity: 10GWh
3. Capex: U\$0.9billion
4. Operation date: January 2024
5. Area: 330,000m<sup>2</sup>
6. KCC Supplied:  
Protective Coatings,  
Epoxy Flooring, Fire Proofing ,  
Ceiling Board , PVC Tile



### ◆ Lotte Chemical Indonesia

1. Location: Cirebon, Indonesia
2. Production capacity: 10GWh
3. Capex: U\$0.9billion
4. Operation date: January 2024
5. Area: 330,000m<sup>2</sup>
6. KCC Supplied:  
Protective Coatings,  
Epoxy Flooring  
Fire Proofing

## ONGOING PROJECTS OF KOREAN COMPANY PLANT- THE STATES

1. HYUNDAI MOTOR GROUP METAPLANT AMERICA(HMGMA), GA / \$5.5billion  
HYUNDAI MOTOR, SK-ON EV BATTERY, LG ENSOL EV BATTERY,  
HYUNDAI MOBIS(#1, #2 ),  
HYUNDAI TRANSIS AND HYUNDAI-STEEL PLANT etc.
2. SAMSUNG ELECTRONICS FAB FOUNDRY : TAYOR, TEXAS / \$25billion
3. SAMSUNG SDI-STELLANTIS EV BATTERY: ST. JOSHEP, INDIANA  
/ \$2.5billion JV
4. LG ENSOL EV BATTERY: ARIZONA #1, #2 PLANT, QUEEN CREEK, ARIZONA  
EXPANSION PLANT: HOLLAND, MICHIGAN /  
\$5.5billion
5. LG CHEC CATHOD PLANT: CLARKSVILLE, TENNESSEE / \$3.2billion
6. FORD-SK JV PLANT: GLENDAL, KENTUCKY(#1, #2 PLANT), STANTON, TN /  
\$5.8billion
7. HANWHA Q CELLS SOLAR PLANT: DALTON, GA / \$2.5billion



HMGMA-HYUNDAI MOTOR PROJECT -PAINT BUILDING

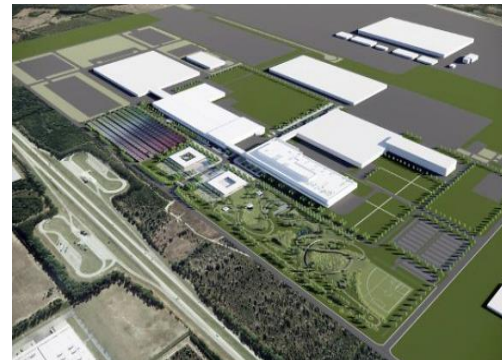

1

## Strong Presence in various Sectors

### *Leading Market Positions in Blue-chip Customer Industries*

				
Protective, Marine & Cargo Container	Automotive OEM	Industrial	Decorative	Refinish
    <b>SAMSUNG HEAVY INDUSTRIES</b>  	   	   <b>WELSPUN</b>   	   <b>Malaysia Regional Distributors: &gt;600</b>	<b>Korea Regional Dealer: 102</b>